



Assembly manual

for joined/ connected units

Connection on **short side**



SOGECO S.A.
L I V I N G

Tools needed

For connecting/ joining the units



Spanner keys

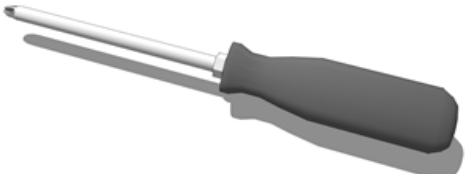

Screw driver for cross head screws



Drill bit



Crowbar

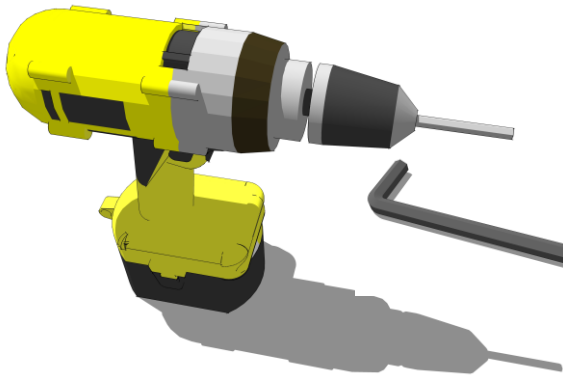

High speed drill with 14mm allen key

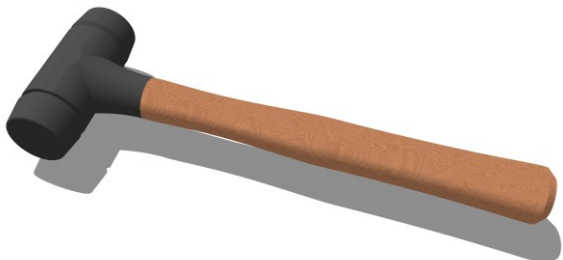

Rubber Hammer



Rubber gloves



1

2

3

4

5

6

7

8

A

A

External

Connection kit set

B

B

C

C

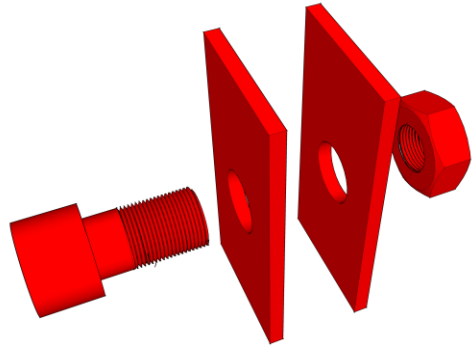

**Horizontal
Connection plate**

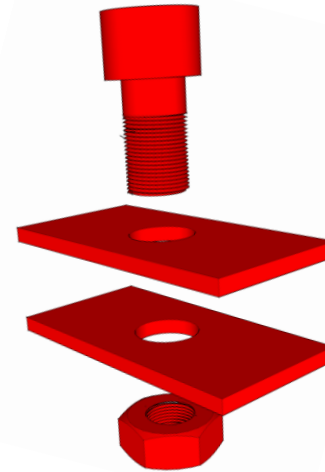

**Vertical
Connection plate**

D

D

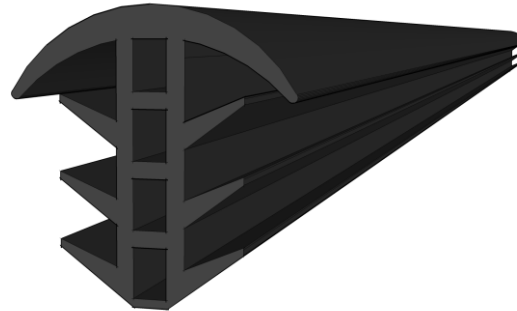

Gasket/ sealing rubber

E

E

F

F



1

2

3

4

5

6

7

1

2

3

4

5

6

7

8

A

A

Internal

Connection kit set

B

B

C

C

D

D

E

E

F

F

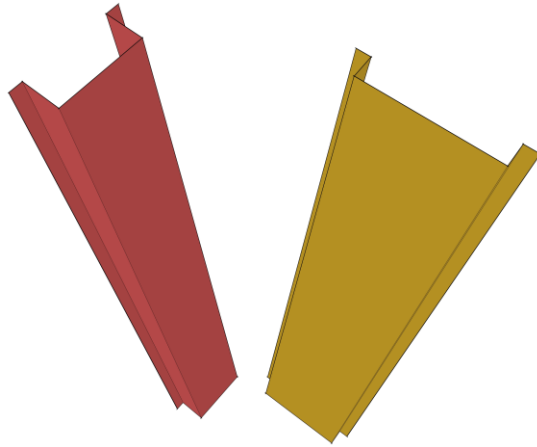

Vertical flashings to cover corner posts connections/ joints

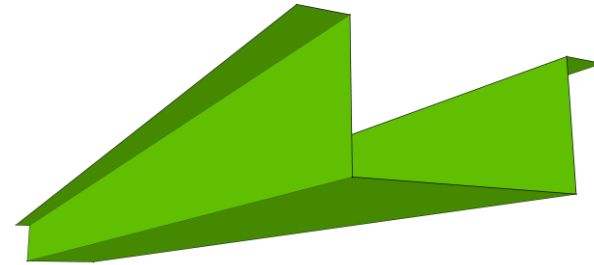

Ceiling flashing to cover Roof frame connections/ joints



Plywood strip floor filler

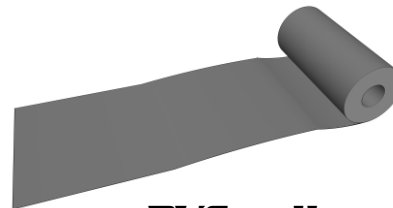

PVC roll floor strip

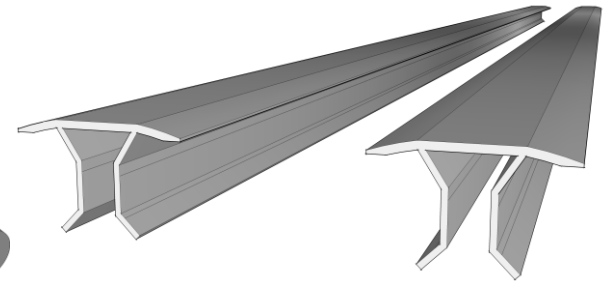

Aluminum floor connector trim



1

2

3

4

5

6

7

1

2

3

4

5

6

7

8

A

A

Connection on *short side*

External side

Position the flatpack containers in location. You can use a crowbar to adjust the alignment of the containers

B

B

C

C

D

D

E

E

F

F

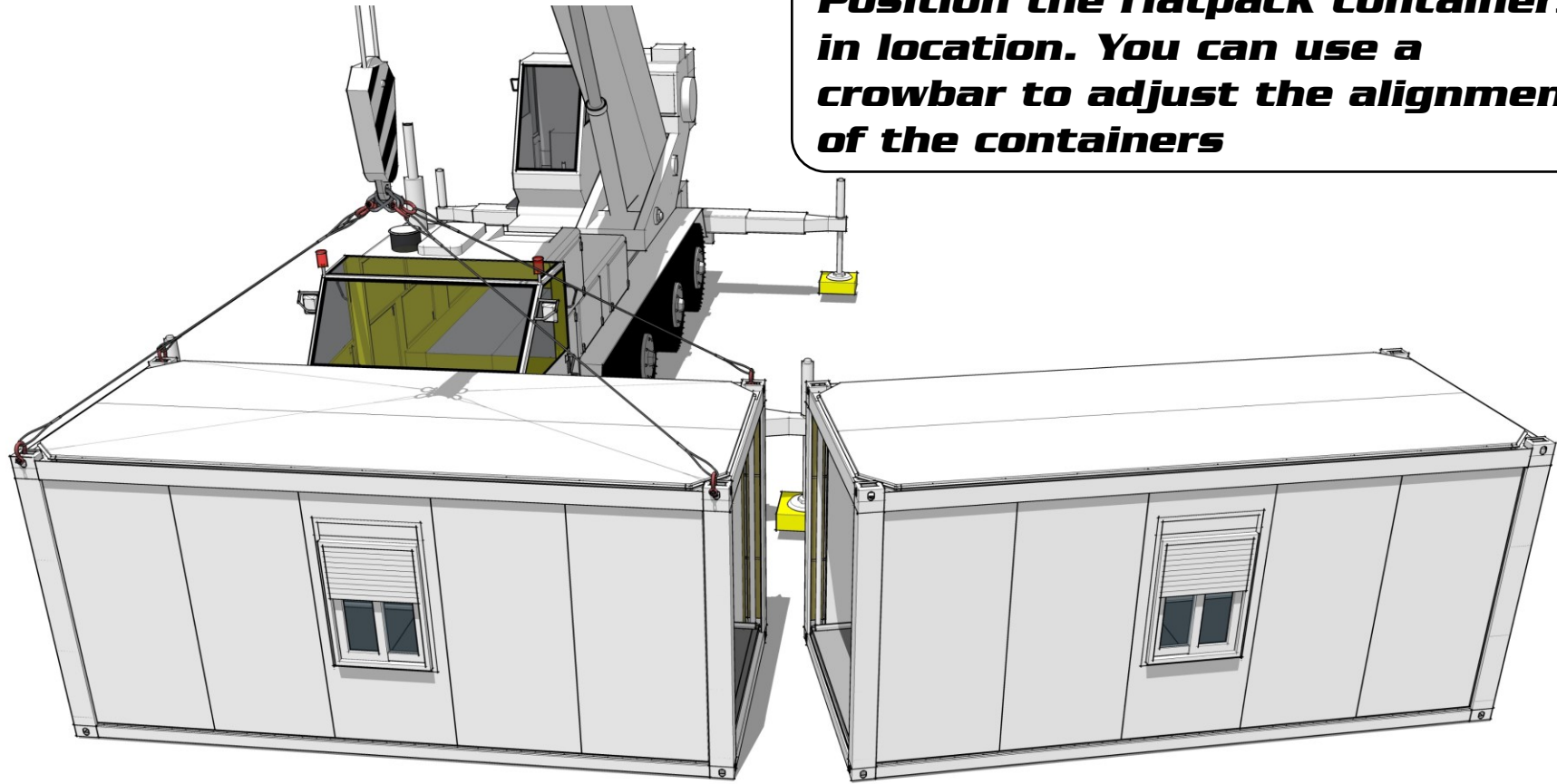

1

2

3

4

5

6

7

1

2

3

4

5

6

7

8

A

B

C

D

E

F

A

B

C

D

E

F

Maintain a 12mm gap between flatpack containers

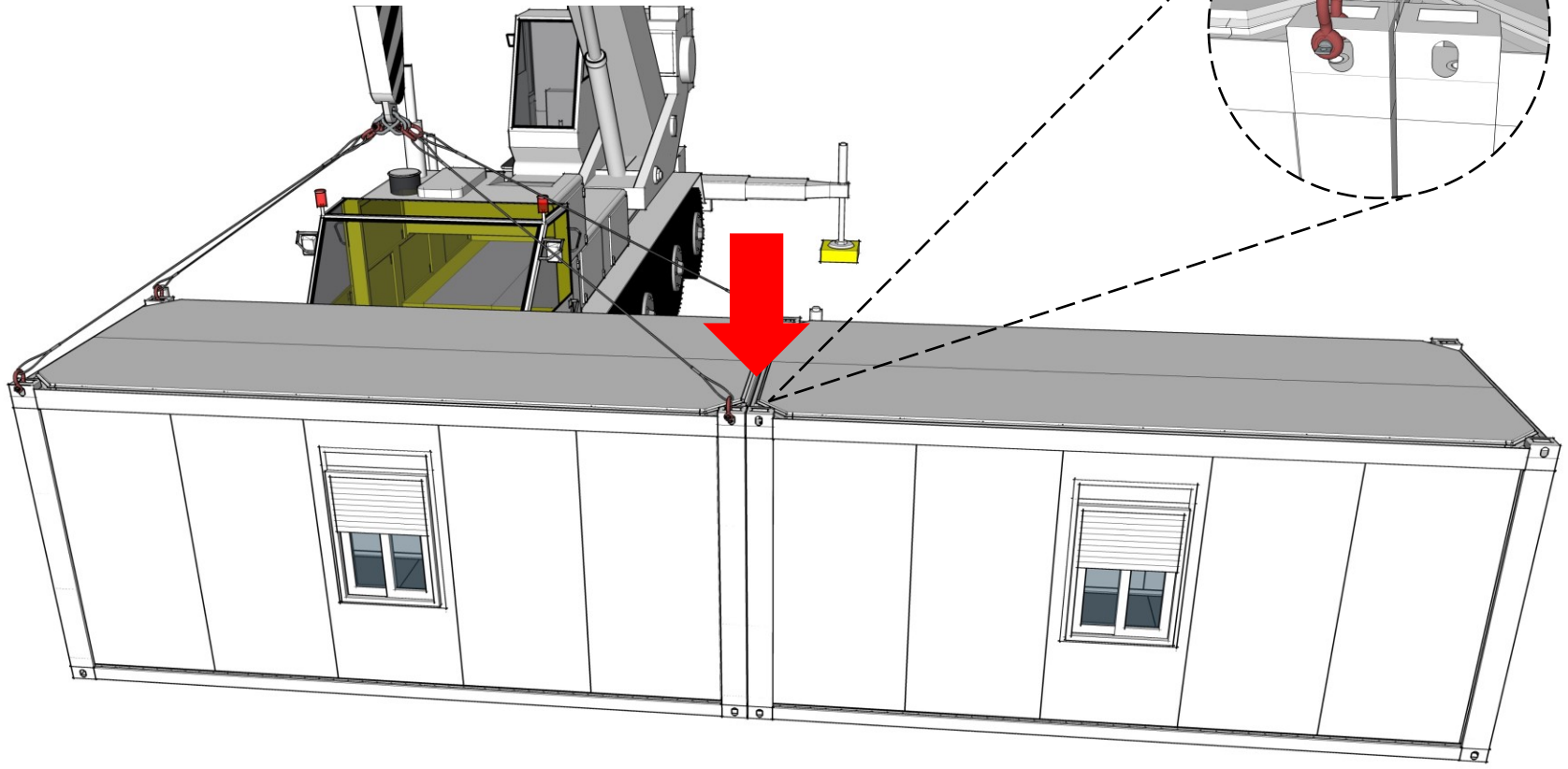
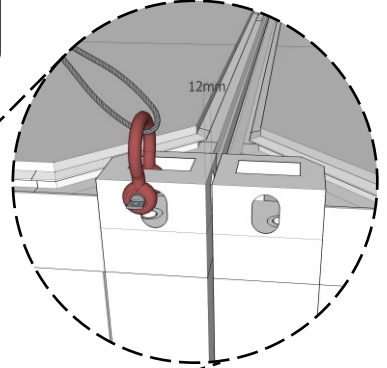

1

2

3

4

5

6

7

1

2

3

4

5

6

7

8

A

B

C

D

E

F

A

B

C

D

E

F

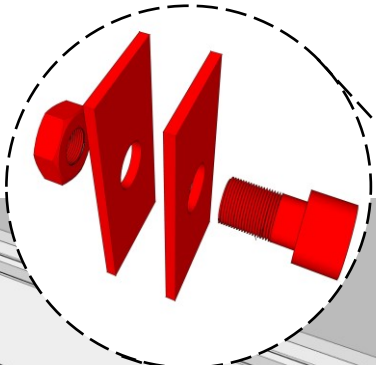

Fix the connection plates on 4 corners. Do not make it tight at this stage.

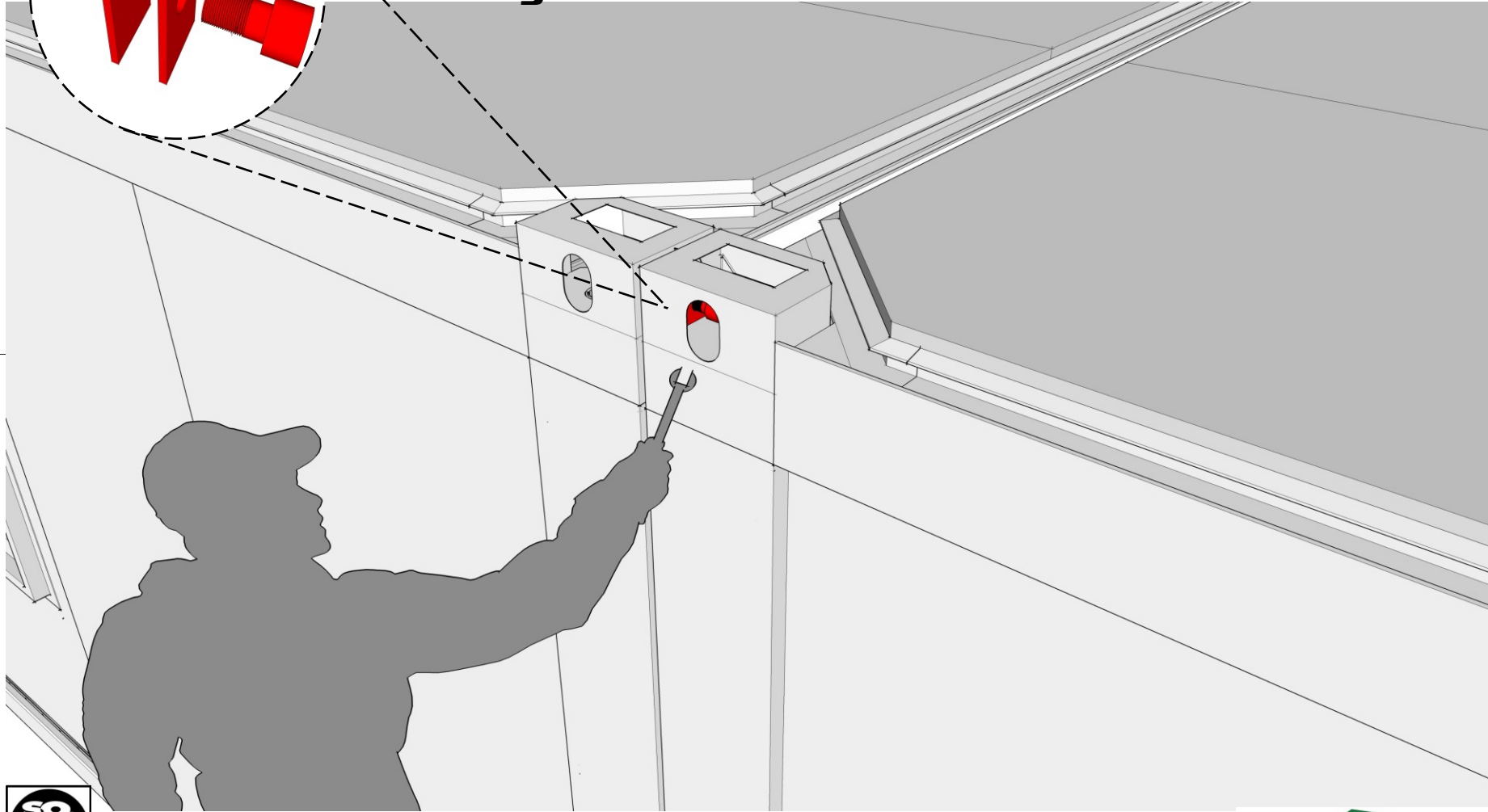

1

2

3

4

5

6

7

1

2

3

4

5

6

7

8

A

A

B

B

C

C

D

D

E

E

F

F



1

2

3

4

5

6

7

2 sets at top corners and 2 sets at bottom corners. Do not make it tight.

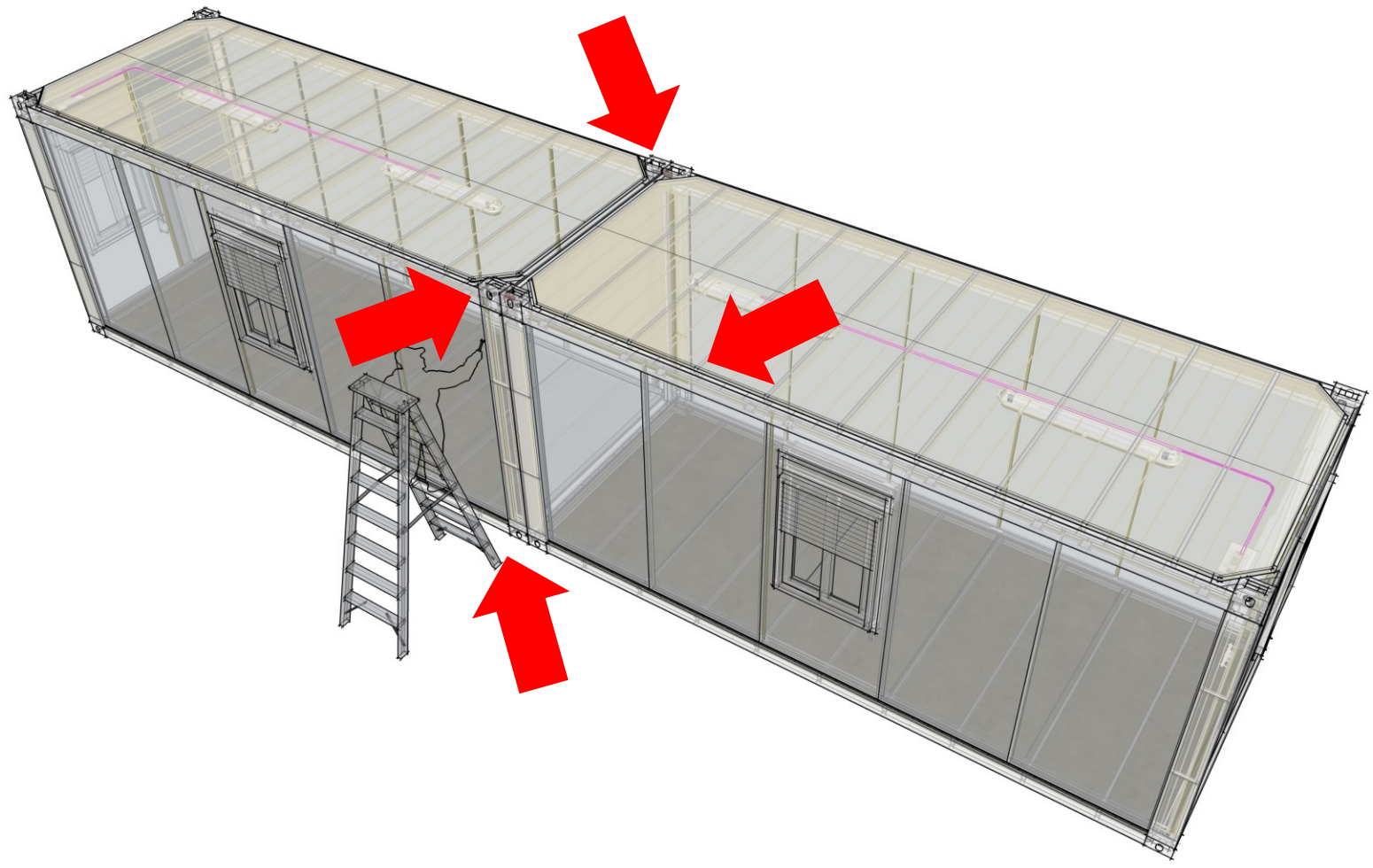

Note:

To avoid water leakage, use 1 pc 9m long sealing rubber all throughout the short side connection. No cut pieces.

Install the sealing rubber all throughout the short side connection. Use rubber hammer to push the rubber in place.

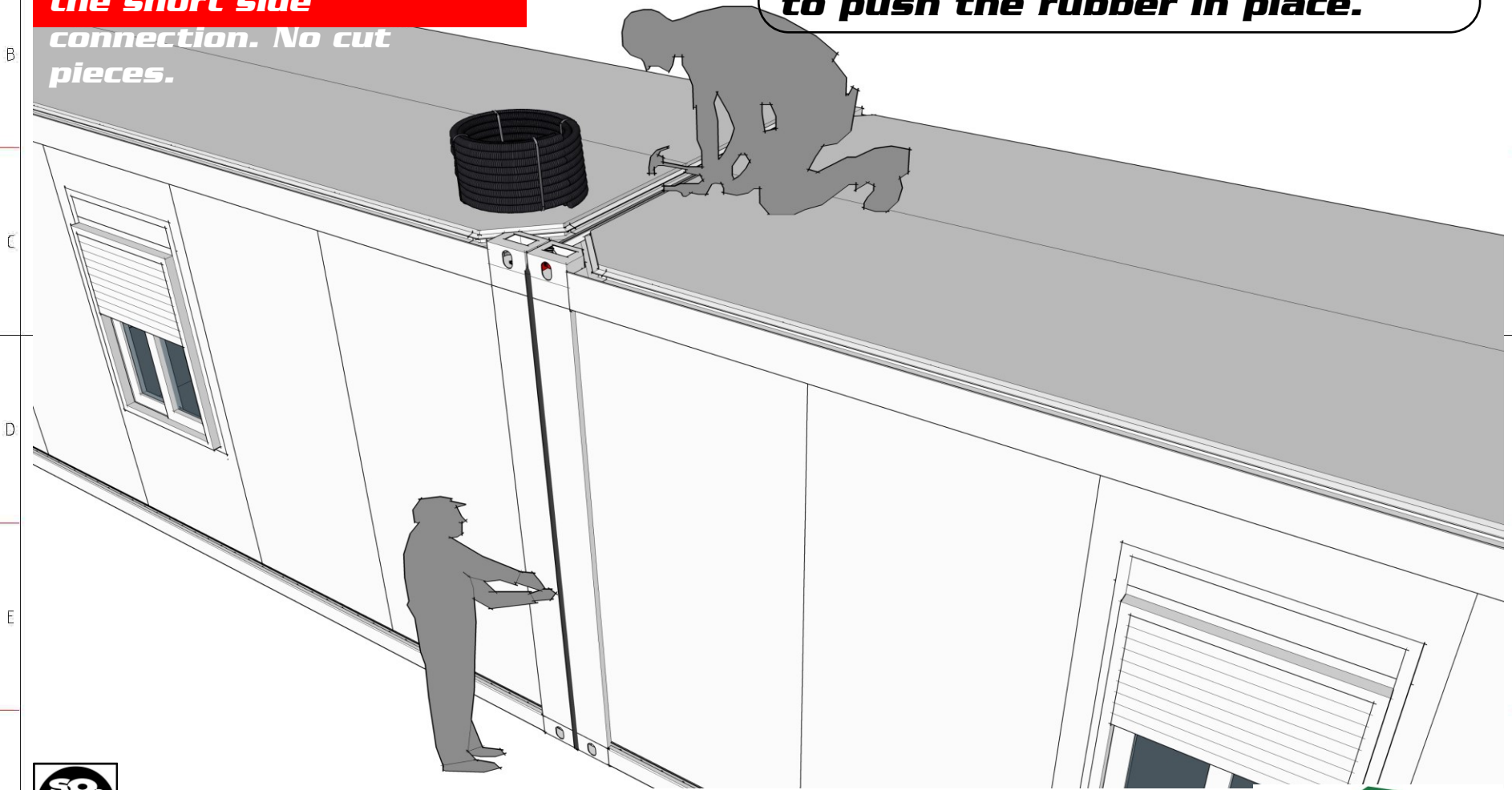

Note:
Make sure sealing
rubber goes around the
top corner as shown
below.

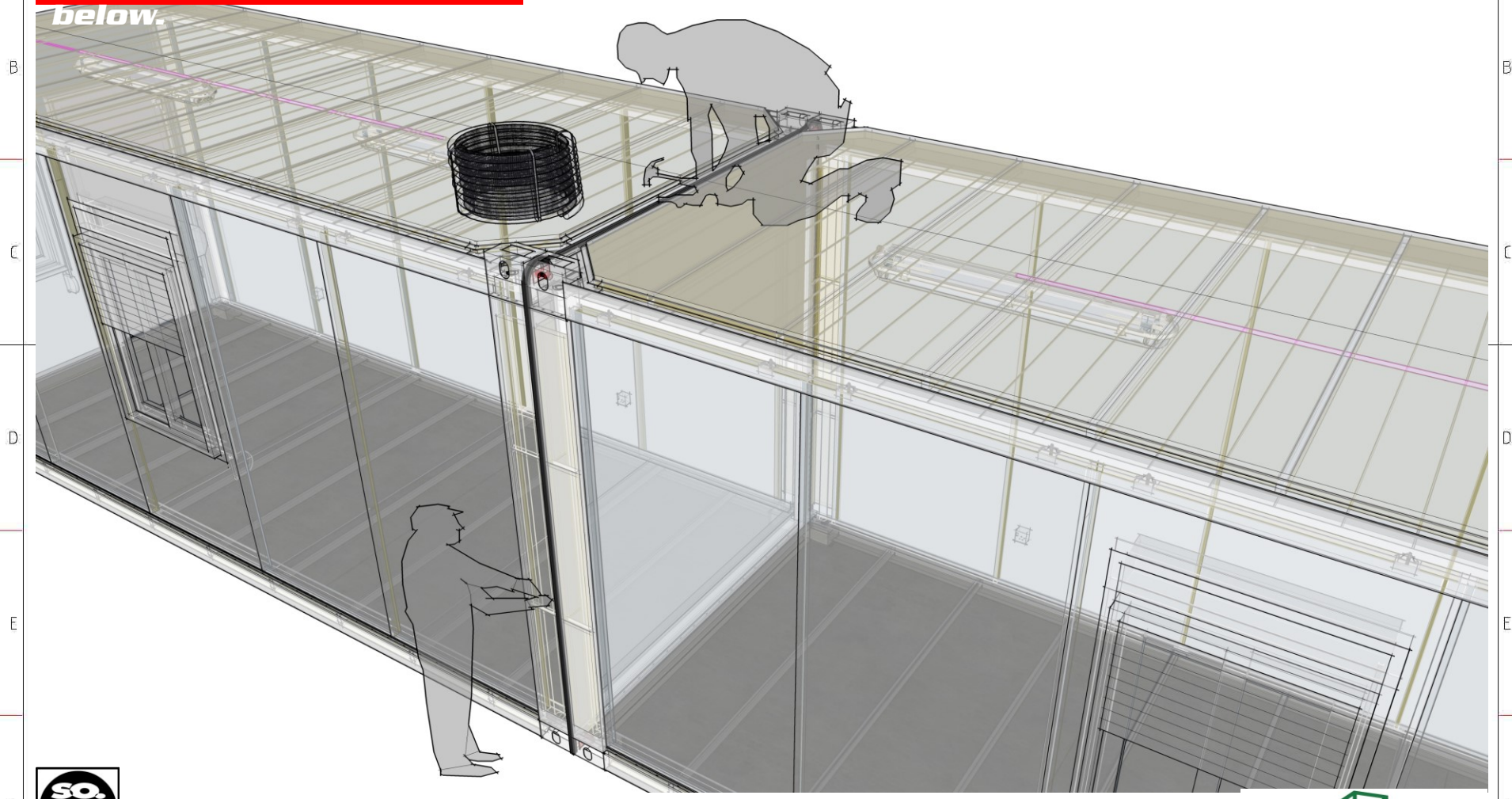

After sealing rubber is installed. Tighten all connection plates. Ensure to maintain consistent gap during tightening all throughout to avoid twisting of frames.

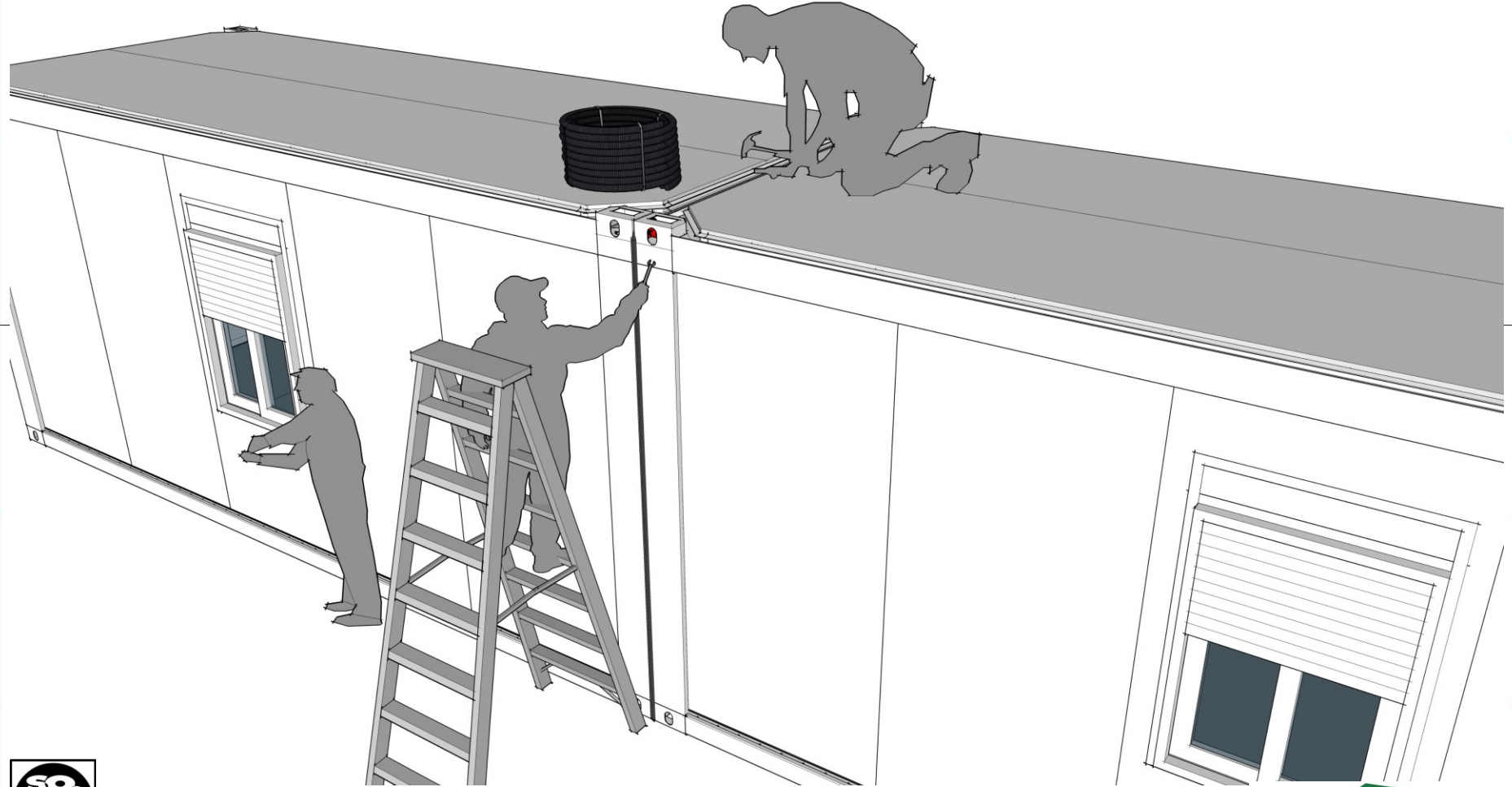

1 2 3 4 5 6 7 8

Connection on *short side*

Internal side

Install the plywood strip floor filler by screwing to floor frame. Center the plywood along the floor gap. There should be a sufficient gap between the plywood and the bump of the floor frame to install the aluminum floor connector trim.

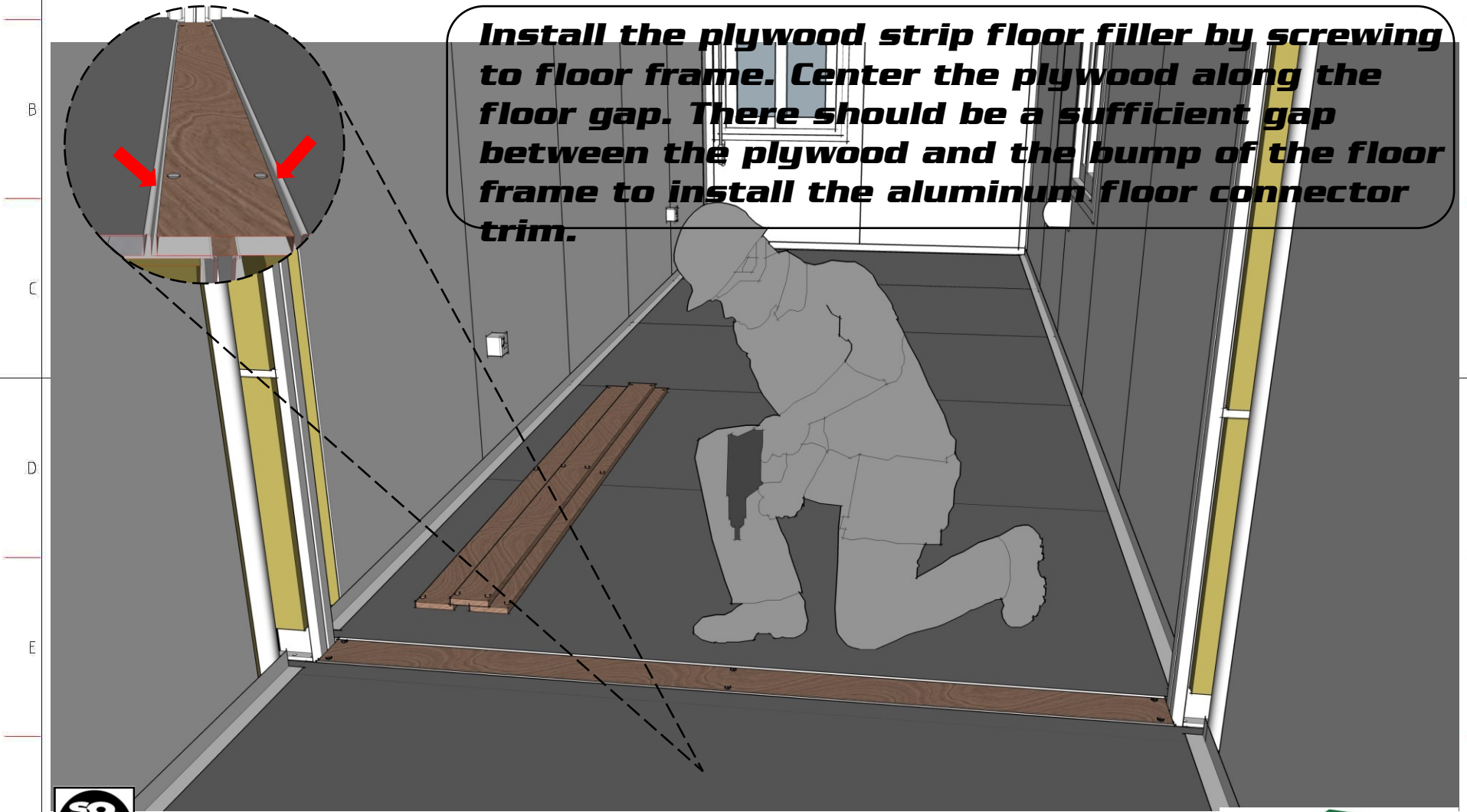
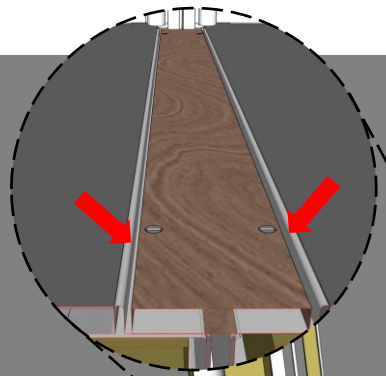

1 2 3 4 5 6 7

Fix the PVC roll floor strip on the plywood strip by glue.



***Install the Vertical flashing
(cover inner post). Cut the top
part to fit. Cutting can be done
in the factory.***

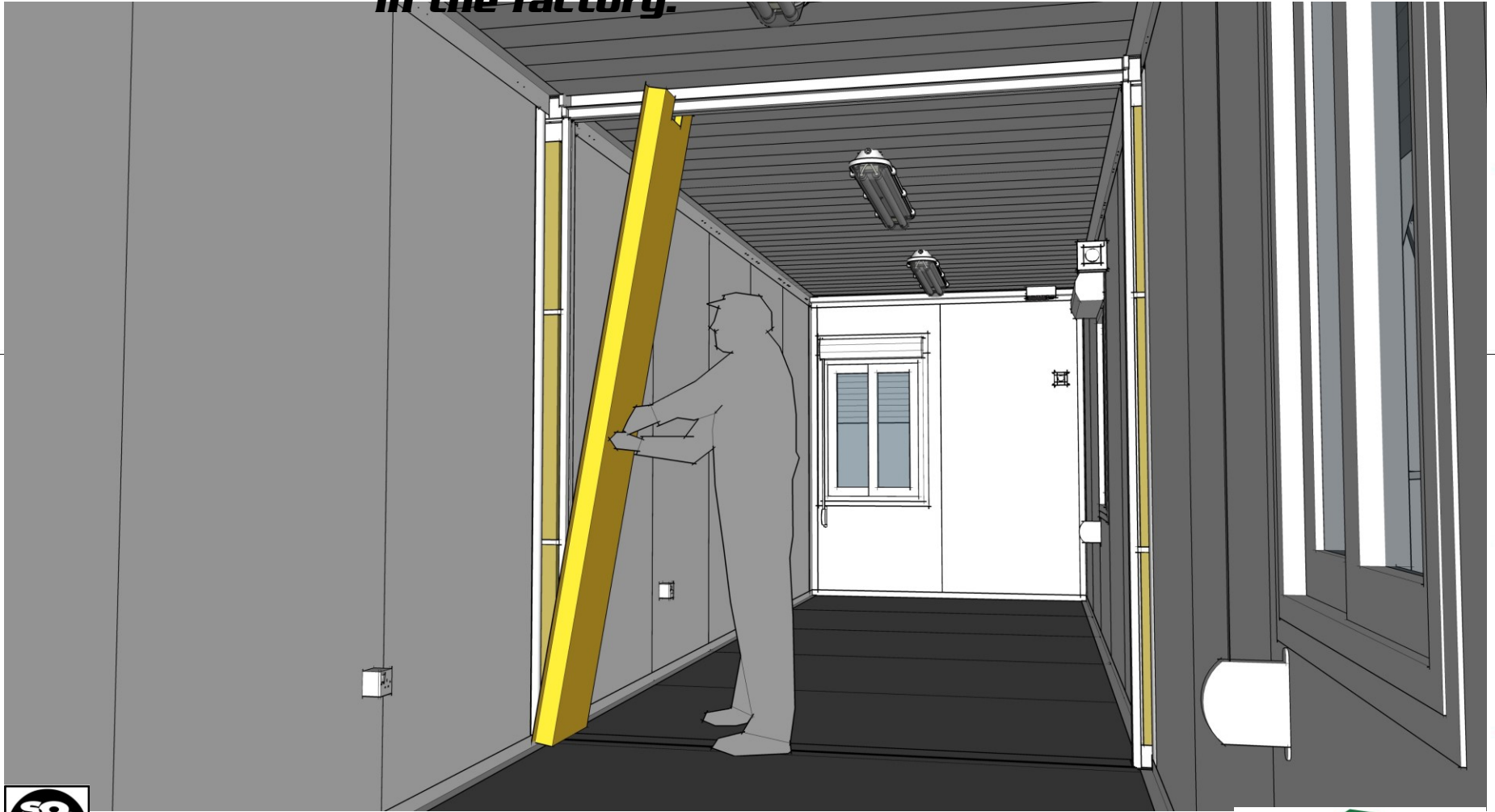

1

2

3

4

5

6

7

8

A

A

***Install the all vertical flashings
in 1 time.***

B

B

C

C

D

D

E

E

F

F

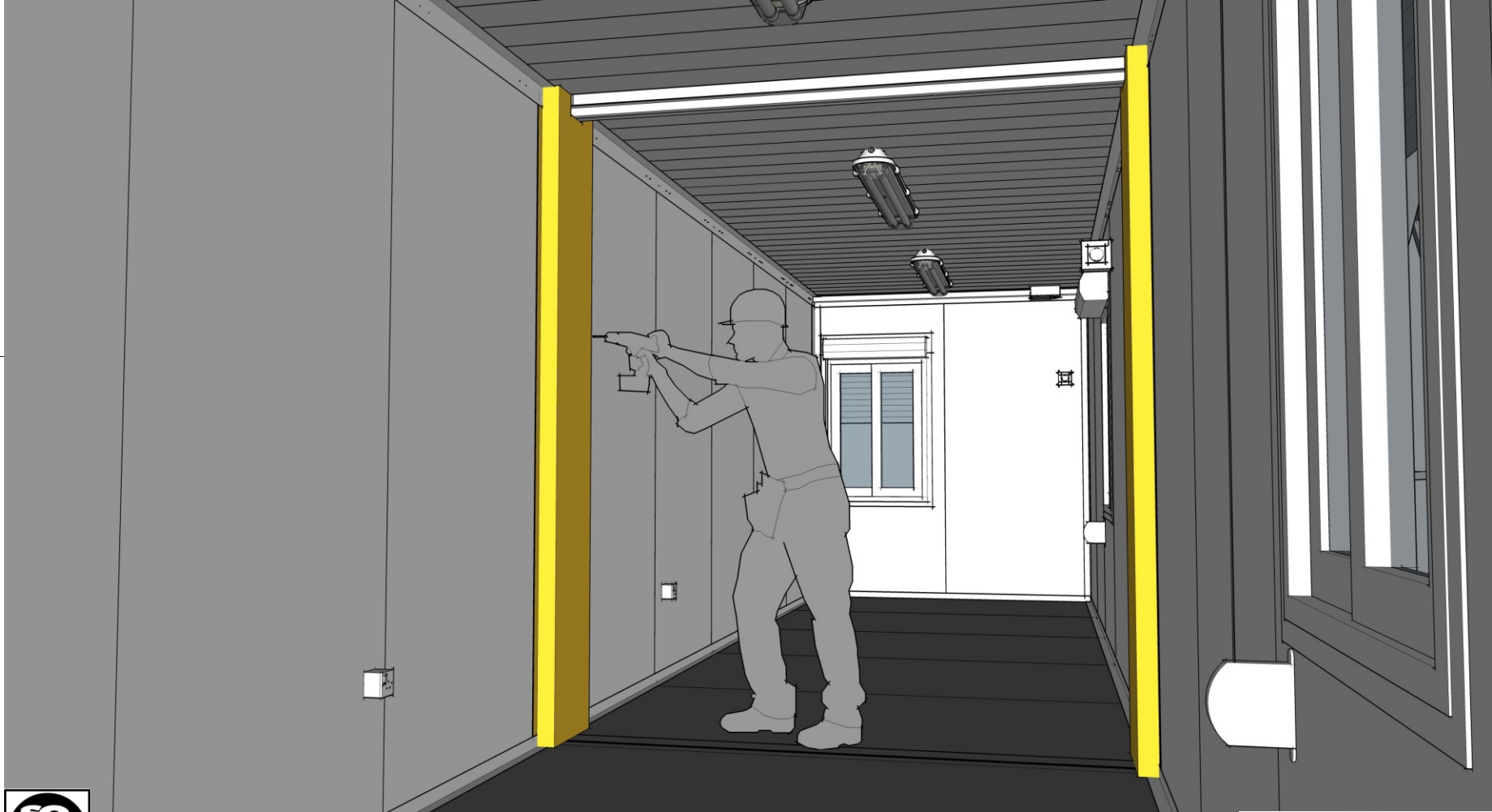

1

2

3

4

5

6

7

Next, install ceiling flashing. Make sure to get the center before fixing it by screw.

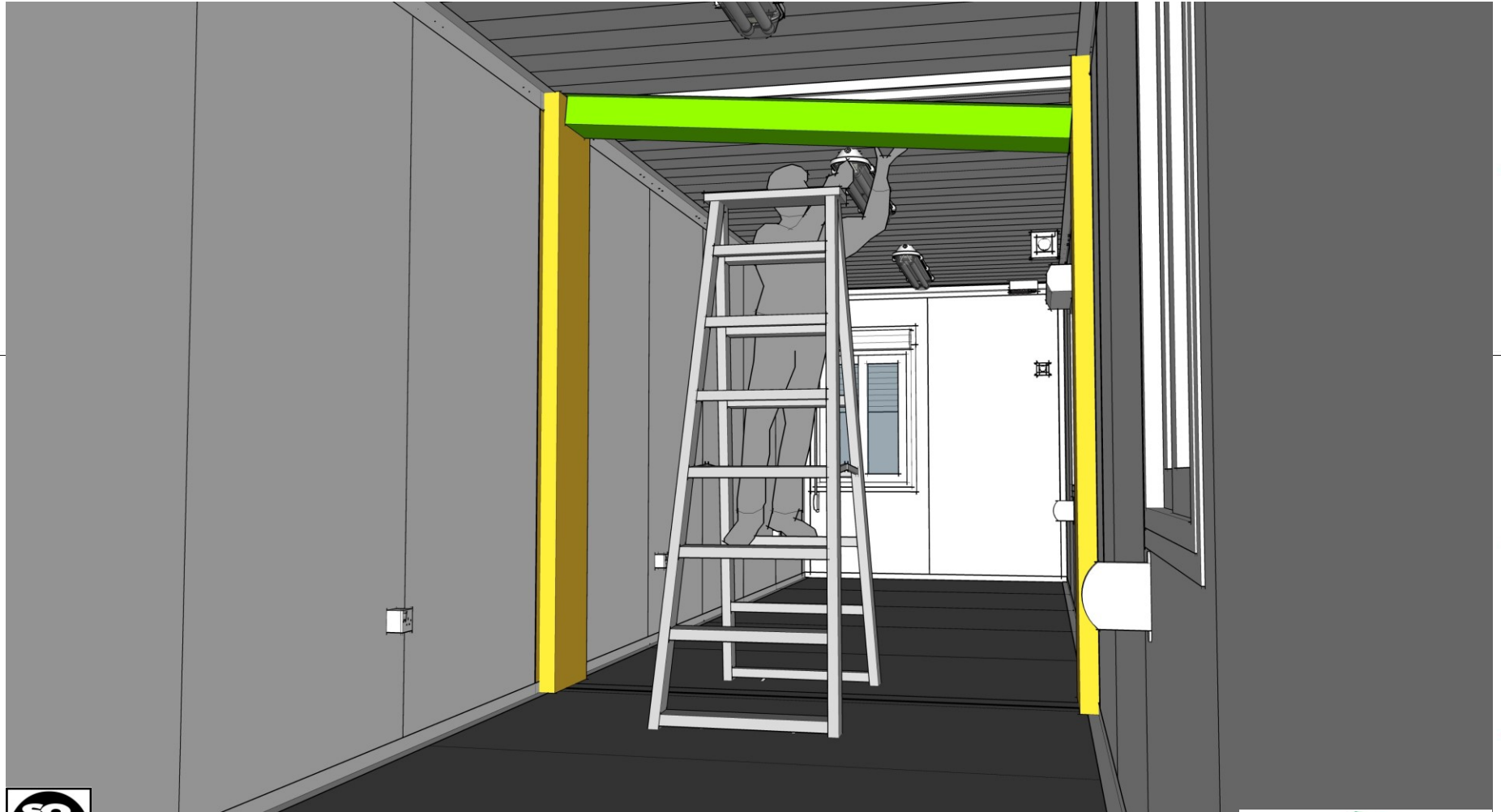

Install the aluminum floor connector trim. These are fix without screws. Insert the groove into the

Push trim to the groove by using rubber hammer

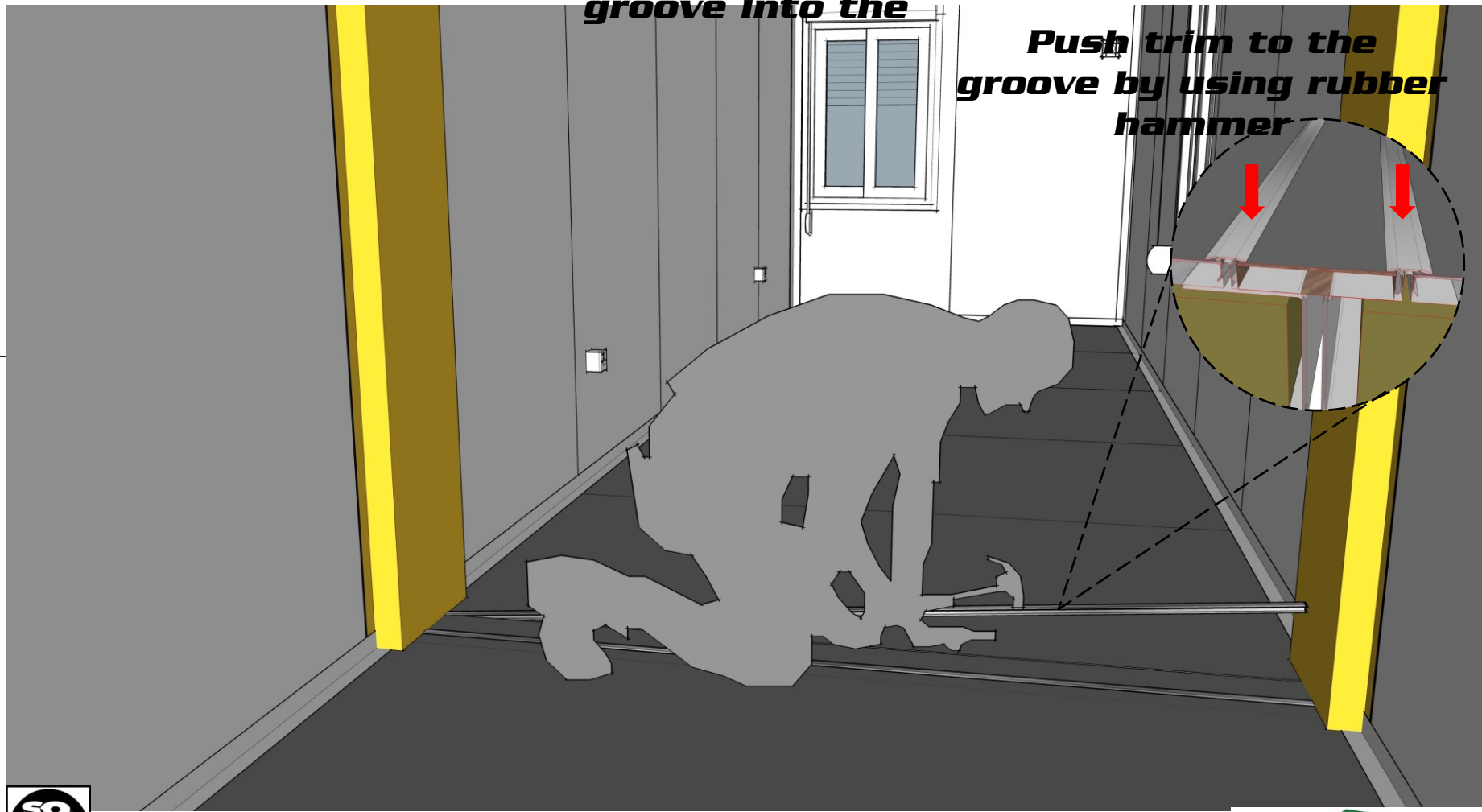
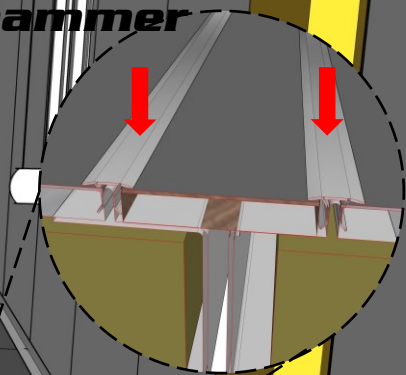

1

2

3

4

5

6

7

8

A

A

Connection on *short side*

External side

B

B

**Sealing
rubber/
gasket**

C

C

**Connectio
n plate
set**

D

D

E

E

F

F

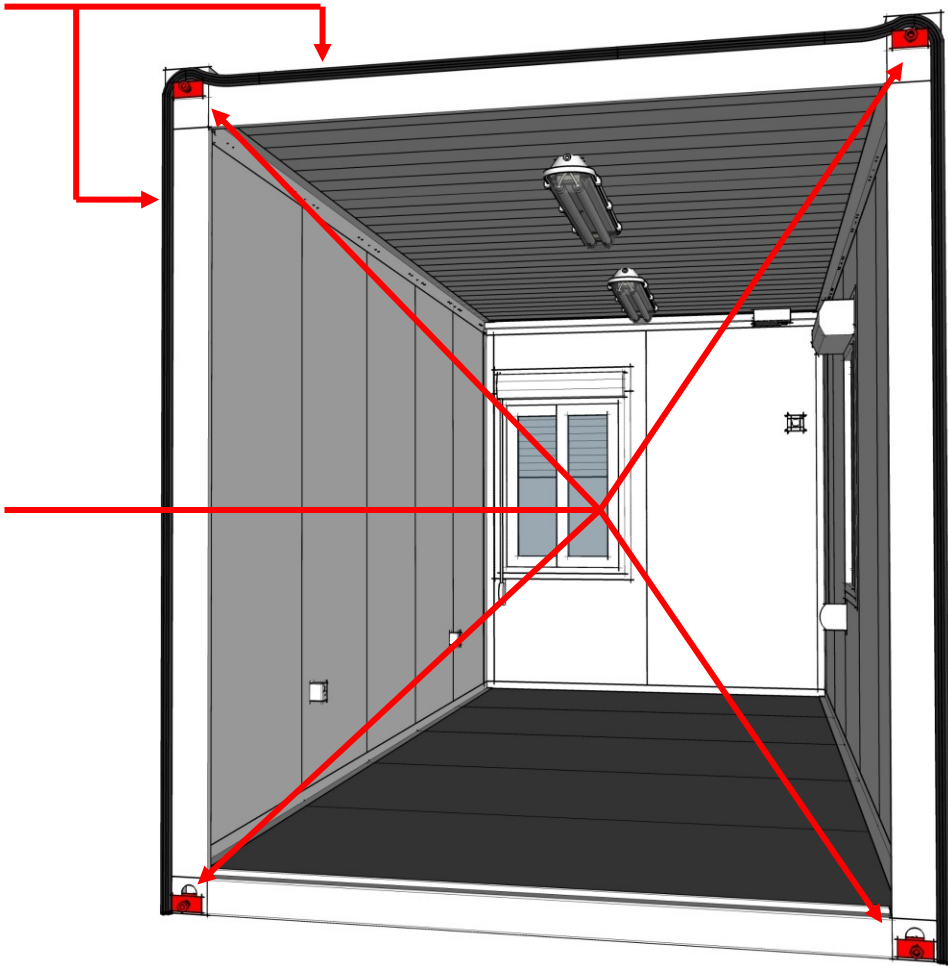

1

2

3

4

5

6

7

1

2

3

4

5

6

7

8

A

A

Connection on *short side*

Internal side

B

B

C

C

D

D

E

E

F

F

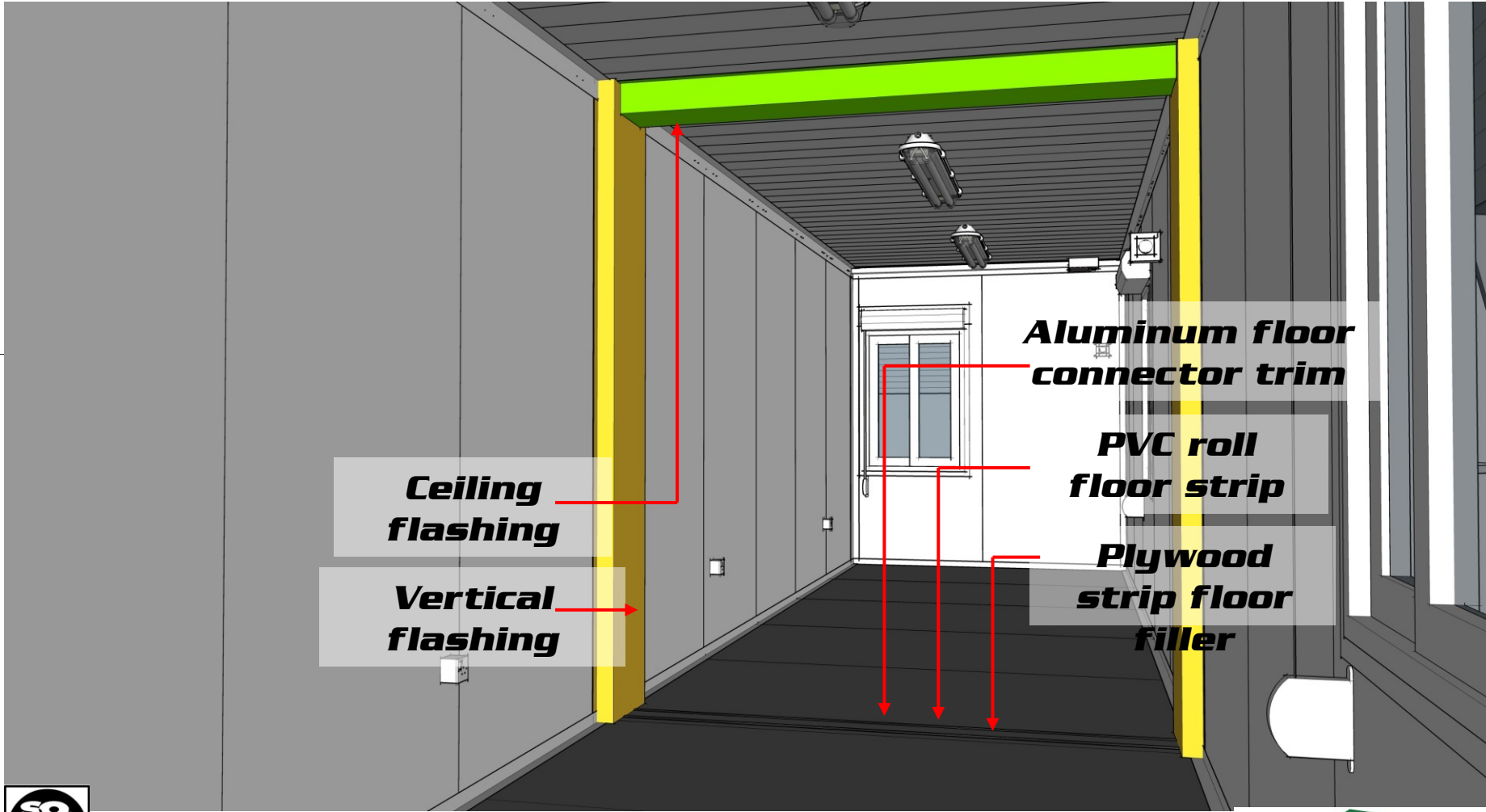

Ceiling flashing

Vertical flashing

Aluminum floor connector trim

PVC roll floor strip

Plywood strip floor filler



1

2

3

4

5

6

7

Lastly, install a rubber trim on all exposed **TOP corner holes **ONLY**. This is to avoid overflowing on water on top corners in case of rain that will leave water stains on corner post paint.**

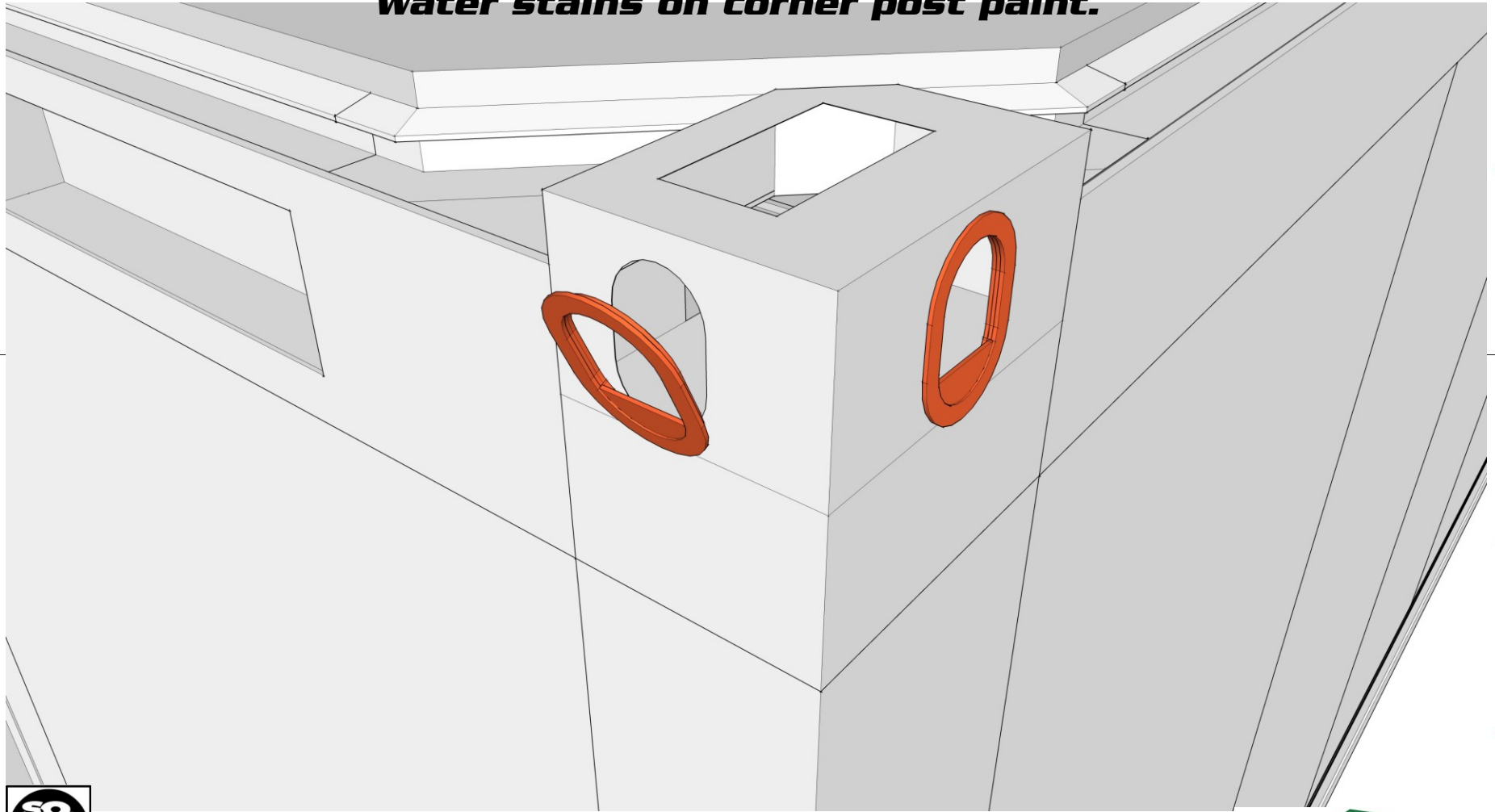

1

2

3

4

5

6

7

8

A

A

B

B

C

C

D

D

E

E

F

F

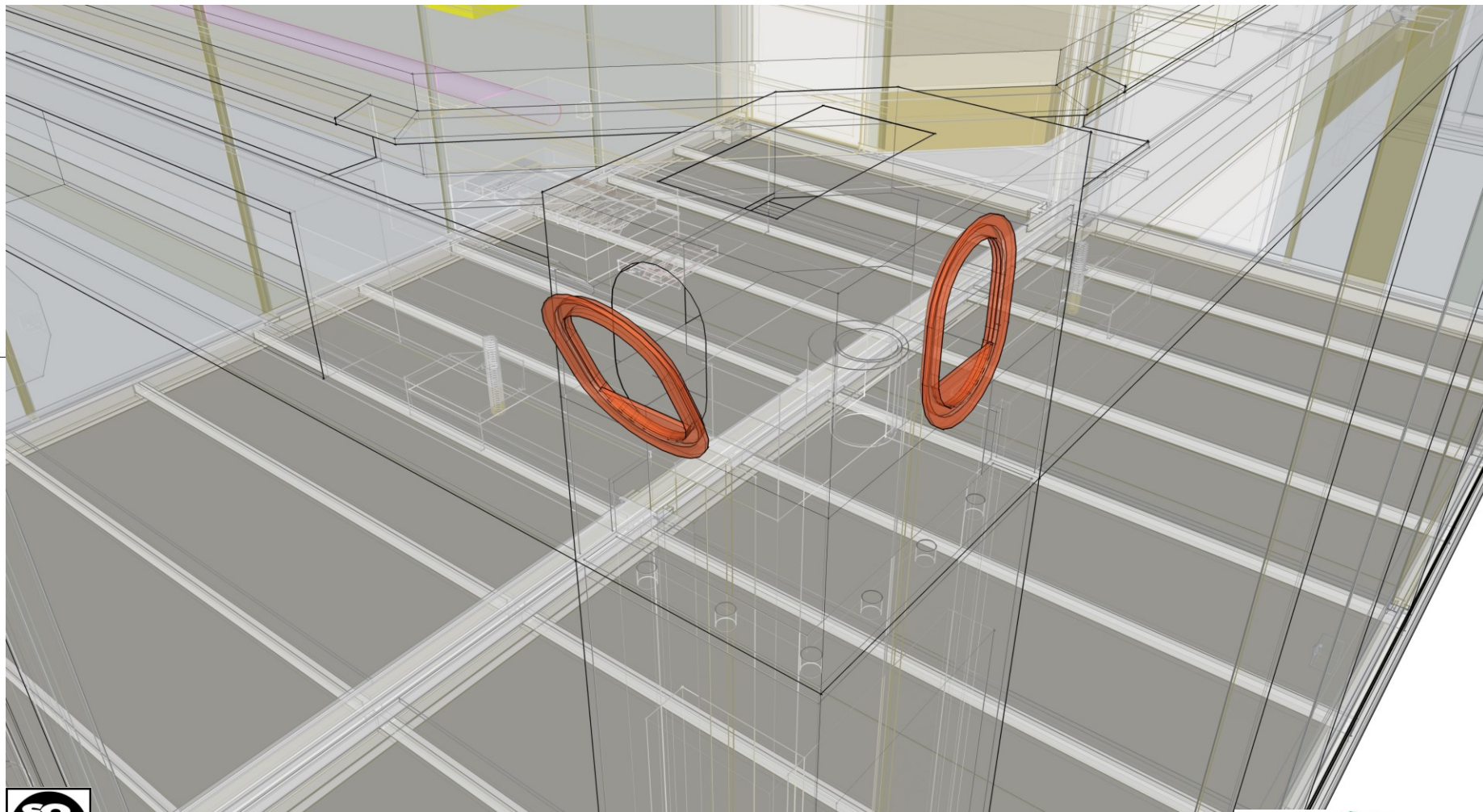

1

2

3

4

5

6

7

8

A

A

B

B

C

C

D

D

E

E

F

F

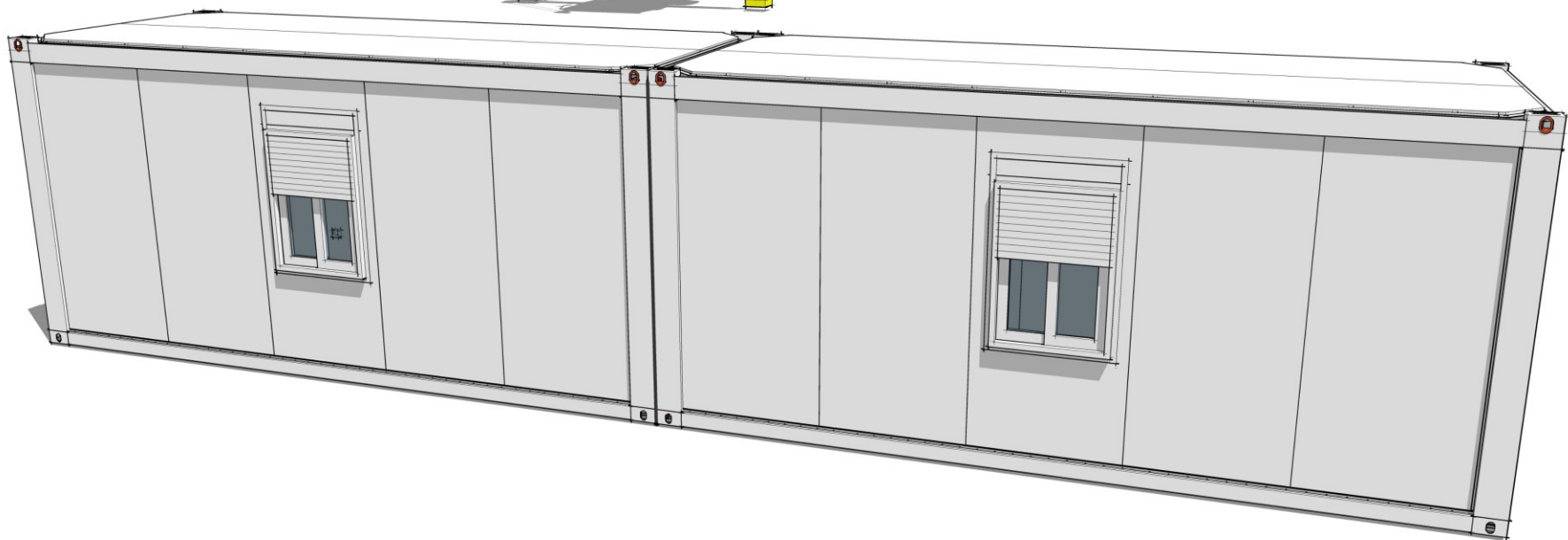
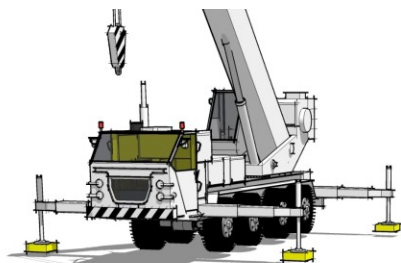

1

2

3

4

5

6

7

1

2

3

4

5

6

7

8

A

B

C

D

E

F

A

B

C

D

E

F

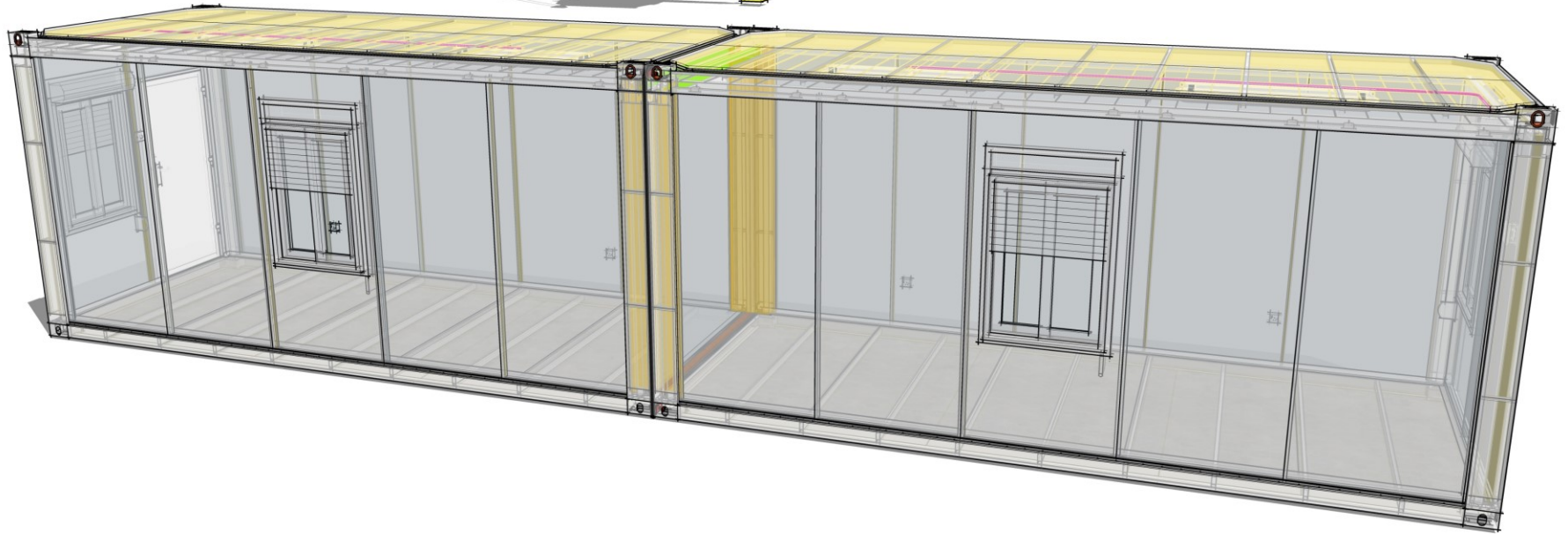
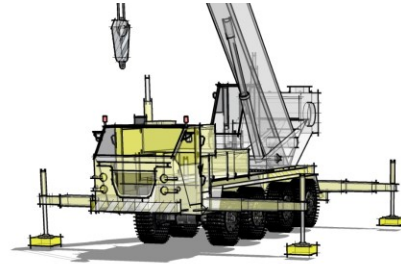

1

2

3

4

5

6

7

8

A

A

B

B

C

C

D

D

E

E

F

F

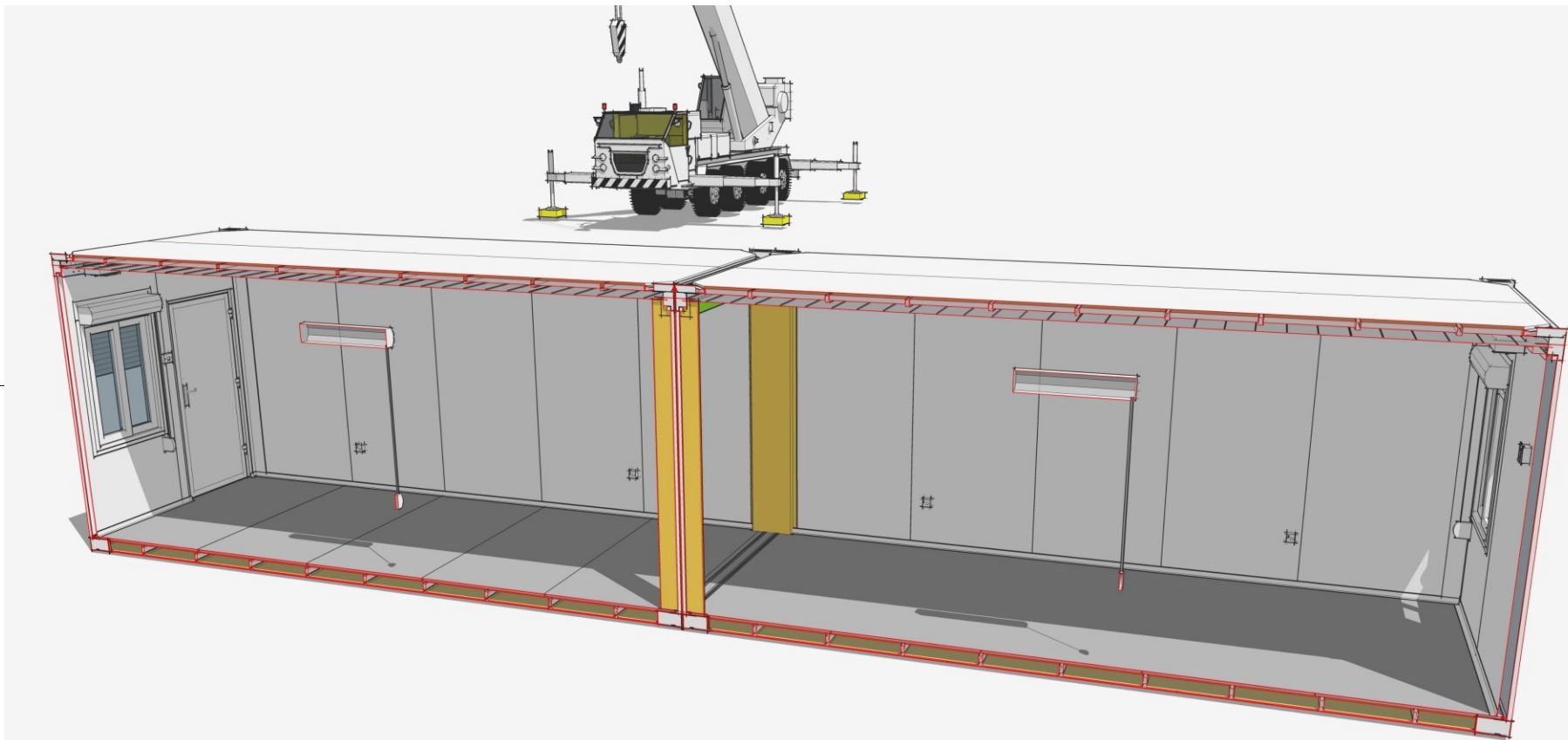

1

2

3

4

5

6

7